



10 SYTCHMILL WAY, STOKE-ON-TRENT, ST6
4GA

SHARED OWNERSHIP £48,000

A three-bedroom semi-detached property situated on Sytchmill Way, available on a shared ownership basis.

The accommodation comprises a good-sized entrance hall providing access to the kitchen and a ground floor W.C., which can also be used as a cloakroom. To the rear of the property is the living/dining room with French doors opening onto the garden.

To the first floor there are three bedrooms and a family bathroom.

Externally, the property has an enclosed rear garden. Parking for two vehicles is located to the rear, positioned behind the garden fence.

The property has approximately 89 years remaining on the lease. The current monthly charge is £308, which includes rent on the remaining share, service charges, buildings insurance and ground rent.

The property is offered on a shared ownership basis through Midland Heart. An application form is required and can be provided upon request. Further details regarding the share available and eligibility criteria are available on enquiry.

Council Borough: Stoke-On-Trent
Council Tax Band: B
Tenure: Leasehold

Ground Floor

Entrance Hall

6'8" x 11'10" (2.054 x 3.626)

W.C.

3'7" x 7'3" (1.107 x 2.223)





Kitchen

7'3" x 7'11" (2.221 x 2.415)

Living and Reception Room

10'7" x 14'4" (3.232 x 4.381)

First Floor

Bedroom One

7'2" x 11'4" (2.185 x 3.466)

Bedroom Two

7'1" x 9'11" (2.173 x 3.024)

Bedroom Three

6'7" x 6'10" (2.026 x 2.094)

Bathroom

5'6" x 6'10" (1.680 x 2.105)

Stephenson Browne AML Disclosure

Agents are required by law to conduct Anti-Money Laundering checks on all those buying a property. Stephenson Browne charge £49.99 plus VAT for an AML check per purchase transaction . This is a non-refundable fee. The charges cover the cost of obtaining relevant data, any manual checks that are required, and ongoing monitoring. This fee is payable in advance prior to the issuing of a memorandum of sale on the property you are seeking to buy.



Floor Plan

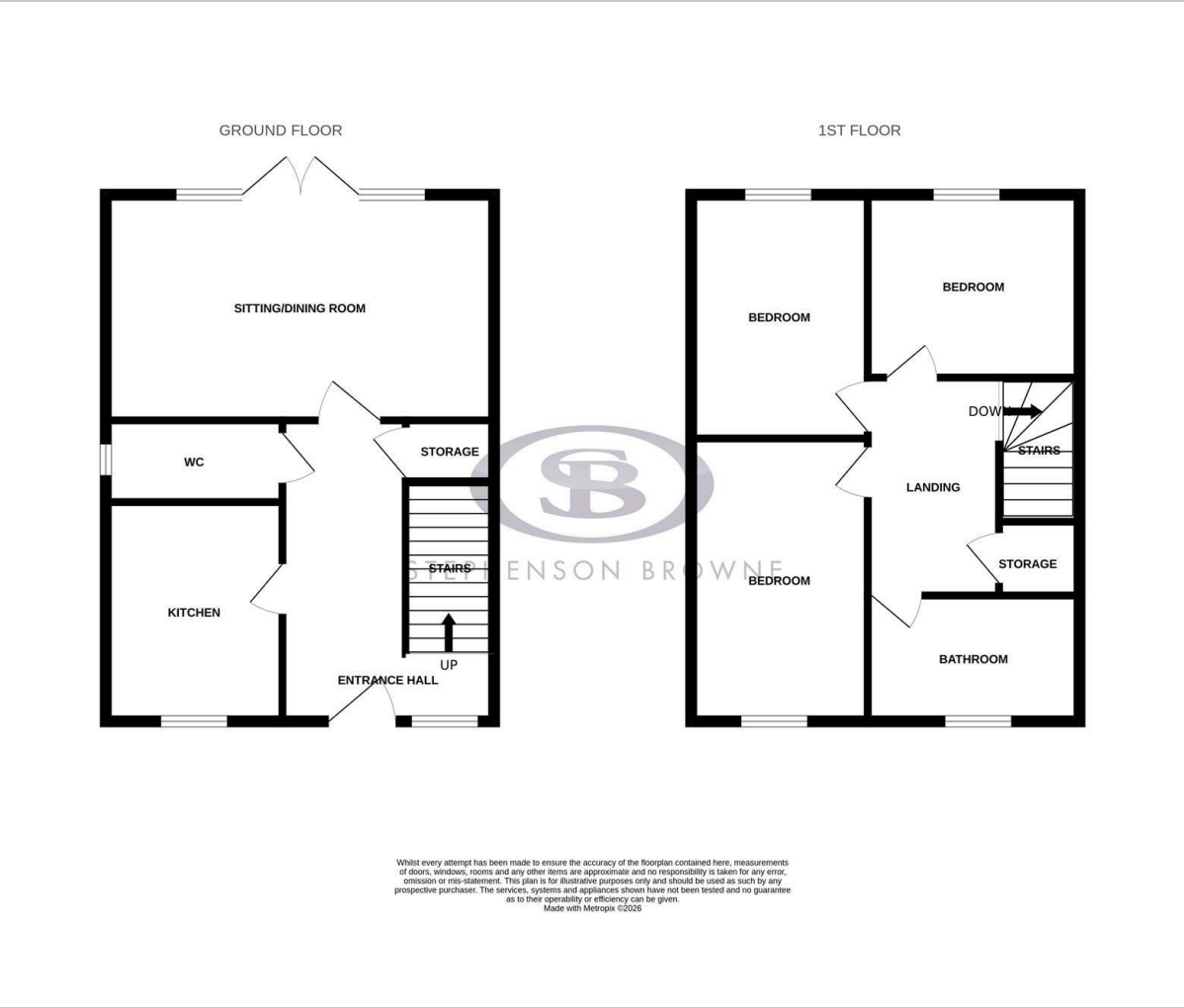

Area Map

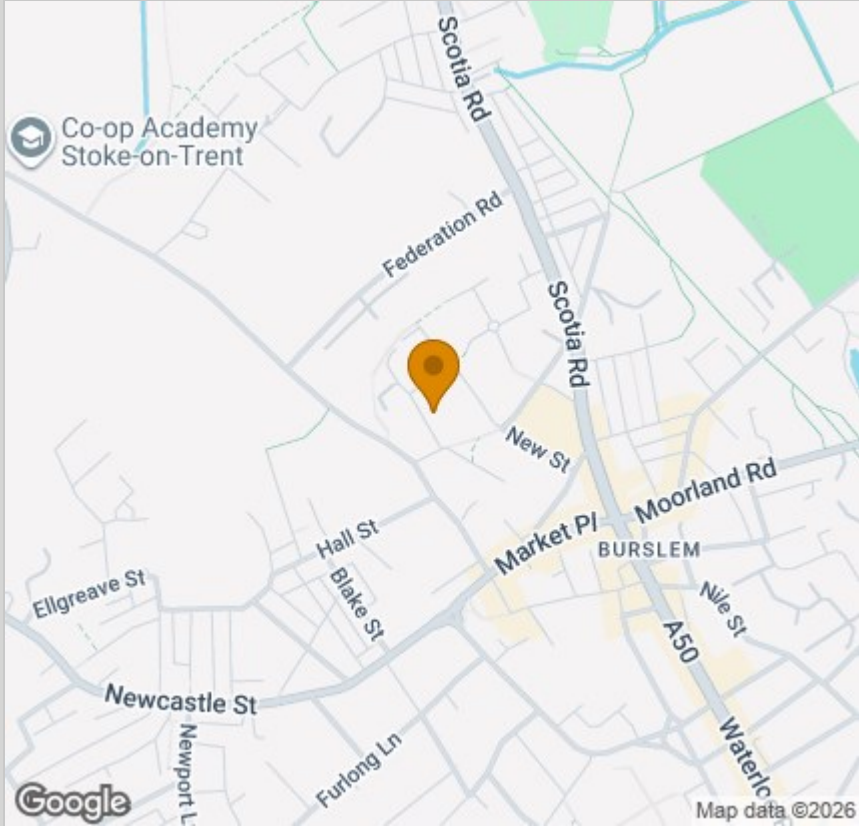

Viewing

Please contact our Newcastle Under Lyme Office on 01782 625734 if you wish to arrange a viewing appointment for this property or require further information.

Energy Efficiency Certificate

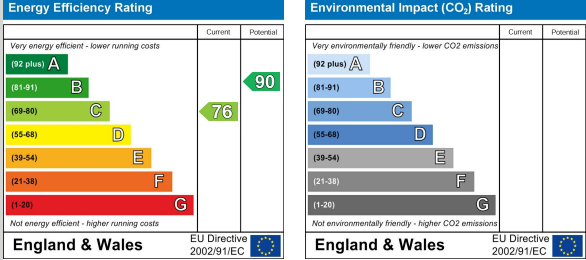

NOTICE: Stephenson Browne for themselves and for the vendors or lessors of this property whose agents they are give notice that: (1) the particulars are set out as a general guideline only for the guidance of intending purchasers or lessees, and do not constitute, nor constitute part of, an offer or contract; (2) all descriptions, dimensions, references to condition and necessary permissions for use and occupation, and other details are given in good faith and are believed to be correct but any intending purchasers or tenants should not rely on them as statements or representations of fact but must satisfy themselves by inspection or otherwise as to the correctness of each theme; (3) no person in the employment of Stephenson Browne has any authority to make representation or warranty whatever in relation to this property. (4) fixtures & fittings are subject to a formal list supplied by the vendors solicitors. **Referring to:** Move with Us Ltd **Average Fee:** £123.64